

8 Hendeley Court, Staffordshire, DE14 2BH

£825 PCM









ABODE LETTINGS are pleased to offer this two bedroomed ground floor apartment situated within easy access of the town centre and train station and close to both the A38 / A444.

The property briefly comprises: Entrance hallway, spacious open plan lounge / kitchen, Two good sized bedrooms and family bathroom with shower over the bath. The property benefits from electric heating and double glazing throughout. Allocated parking space. Available NOW

#### DESCRIPTION

ABODE LETTINGS are pleased to offer this two bedroomed apartment situated within easy access of the town centre and train station and close to both the A38 / A444.

The property briefly comprises: Entrance hallway, spacious open plan lounge / kitchen, Two good sized bedrooms and family bathroom with shower over the bath. The property benefits from electric heating and double glazing throughout. Available late January 2022.











Floor Plans

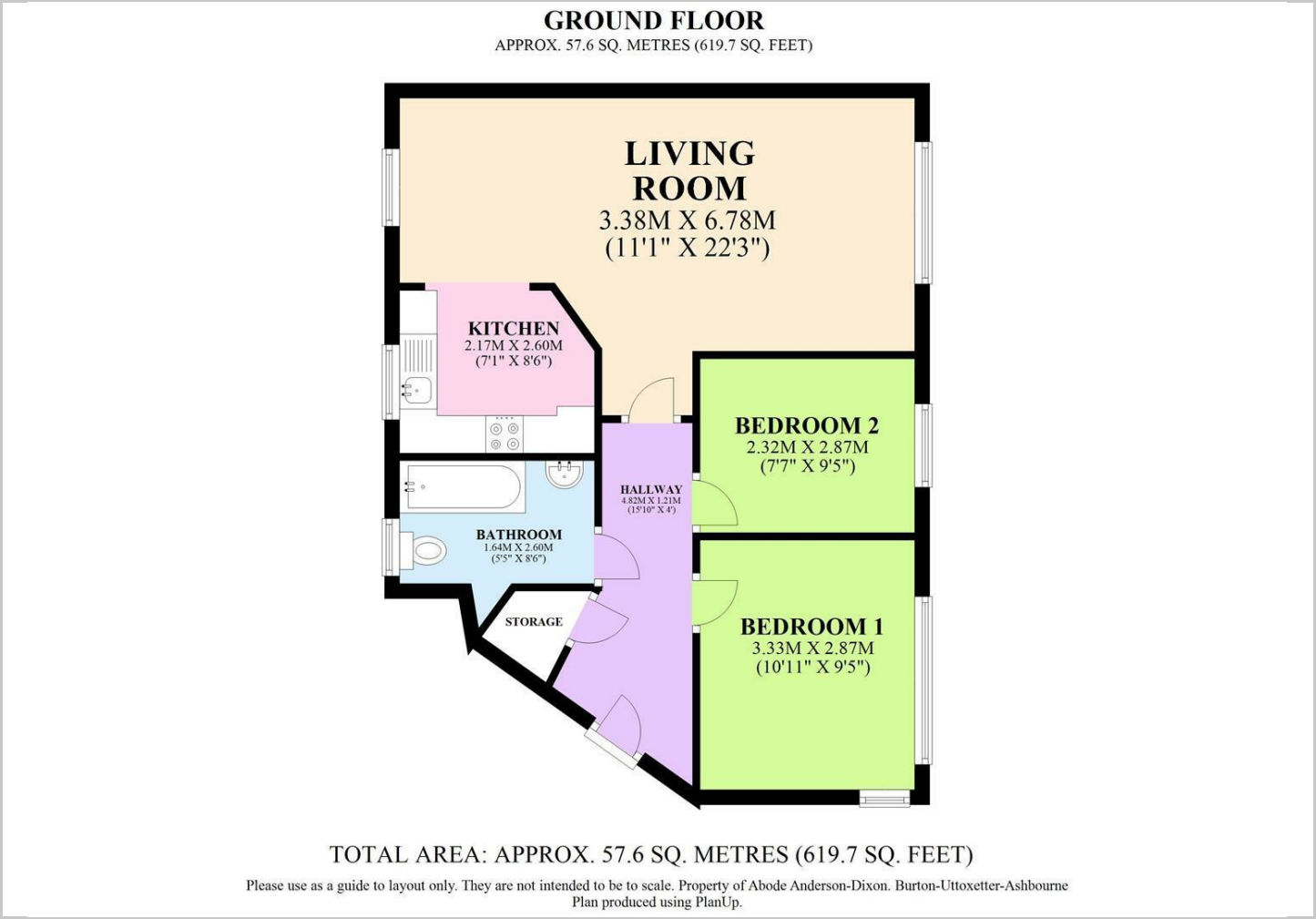

Location Map

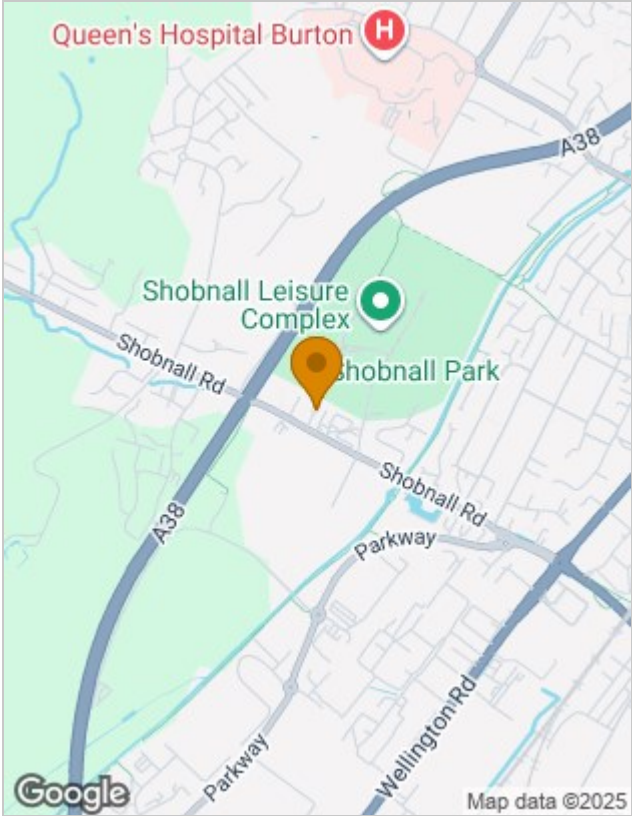

Energy Performance Graph

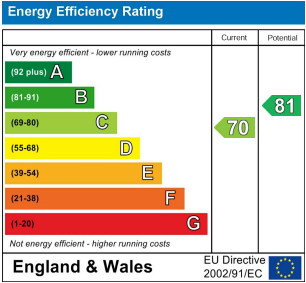

Please contact our Burton Lettings Office on 01283 845888 if you wish to arrange a viewing appointment for this property or require further information.

The particulars are set out as a general outline only for the guidance of intended purchasers or lessees, and do not constitute, any part of a contract. Nothing in these particulars shall be deemed to be a statement that the property is in good structural condition or otherwise nor that any of the services, appliances, equipment or facilities are in good working order. Purchasers should satisfy themselves of this prior to purchasing.